

CORNER RECORD

Agency Index BK 144 PG 96
Document Number CR 15227

City of OAKLAND County of ALAMEDA, California
Brief Legal Description MONUMENT ON 3RD AVE, WEST OF THE INT. OF 3RD AVE & WAYNE PL

CORNER TYPE

COORDINATES (Optional)

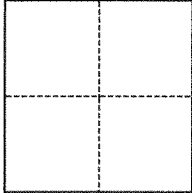

☐ Government Corner ☒ Control
☐ Meander ☐ Property
☐ Rancho ☐ Other

Date of Survey March 9, 2021

N. _____ E. _____

Elevation _____

Units ☐ Metric ☒ U.S. Survey Foot

Horizontal Datum _____

Zone _____ Epoch Date _____

Vertical Datum _____

☐ Complies with Public Resources Code §§8801-8819

☐ Complies with Public Resources Code §§8890-8902

PLS Act Ref.: ☐ 8765(d) ☒ 8771 ☐ 8773 ☐ Other:

Corner/
Monument: ☒ Left as found ☐ Established ☐ Rebuilt ☒ Pre-Construction
☐ Found and tagged ☐ Reestablished ☒ Referenced ☐ Post-Construction

Narrative of corner identified and monument as found, set, reset, replaced, or removed:

☒ See sheet #2 for description(s):

SURVEYOR'S STATEMENT

This Corner Record was prepared by me or under my direction in conformance with

the Professional Land Surveyors' Act on

Signed Joseph M. Brajkovich P.L.S. or R.C.E. No. 5254

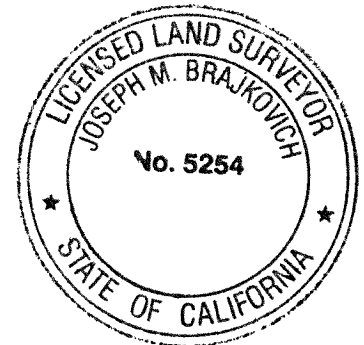

COUNTY SURVEYOR'S STATEMENT

This Corner Record was received _____

and examined and filed JAN 12 2022

Signed D. Ian Wilson P.L.S. or R.C.E. No. 7010

Title ALAMEDA COUNTY SURVEYOR

County Surveyor's Comment

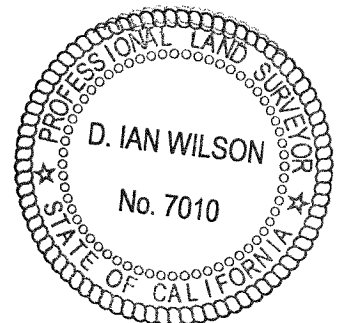



SCALE: 1" = 20'

WAYNE PL

331 WAYNE PL
APN: 21-224-37

3RD AVE

CUT CROSS
IN WALK

155' TO INTERSECTION
CENTERLINE,
CENTERLINE OF 3RD
AVE AND WAYNE PL

CUT CROSS
IN CURB

CUT CROSS
IN CURB

LEGEND



CUT CROSS



FOUND SURVEY MONUMENT
(1/8" PIN IN CONC IN WELL)

APN

ASSESSOR'S PARCEL NUMBER

21007-021821