

# CORNER RECORD

Agency Index \_\_\_\_\_

Document Number CR 10049City of BERKELEY County of ALAMEDA, CaliforniaBrief Legal Description Found 1/8" Pin Monument (B0888) on Gilman St. near Curtis St.

CORNER TYPE		COORDINATES (Optional)	
<input type="checkbox"/> Government Corner	<input type="checkbox"/> Control	N. _____	E. _____
<input type="checkbox"/> Meander	<input type="checkbox"/> Property	<input type="checkbox"/> Elevation	
<input type="checkbox"/> Rancho	<input type="checkbox"/> Other	<input checked="" type="checkbox"/> Units	Metric <input type="checkbox"/> U.S. Survey Foot <input type="checkbox"/>
Date of Survey <u>May 25, 2017</u>		Horizontal Datum _____	
		Zone _____ Epoch Date _____	
		Vertical Datum _____	
		<input type="checkbox"/> Complies with Public Resources Code §§8801-8819	
		<input type="checkbox"/> Complies with Public Resources Code §§8890-8902	

PLS Act Ref.:	<input type="checkbox"/> 8765(d)	<input checked="" type="checkbox"/> 8771	<input type="checkbox"/> 8773	<input type="checkbox"/> Other:
Corner/ Monument:	<input type="checkbox"/> Left as found	<input type="checkbox"/> Established	<input type="checkbox"/> Rebuilt	<input checked="" type="checkbox"/> Pre-Construction
	<input type="checkbox"/> Found and tagged	<input type="checkbox"/> Reestablished	<input type="checkbox"/> Referenced	<input type="checkbox"/> Post-Construction

Narrative of corner identified and monument as found, set, reset, replaced, or removed:

☐ See sheet #2 for description(s):

## SURVEYOR'S STATEMENT

This Corner Record was prepared by me or under my direction in conformance with

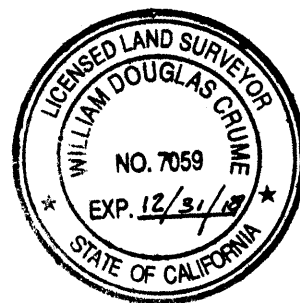
the Professional Land Surveyors' Act on JUNE 26, 2017Signed William Douglas Crume P.L.S. or R.C.E. No. 7059

## COUNTY SURVEYOR'S STATEMENT

This Corner Record was received 25 MAY, 2017and examined and filed 19 JULY, 2017Signed Michael Rubner P.L.S. or R.C.E. No. 6843Title COUNTY SURVEYOR

County Surveyor's Comment \_\_\_\_\_



