

RECORD OF SURVEY NO. 36 - 120

BEING A SURVEY OF LOT LINE ADJUSTMENT 95-4 RECORDED IN VOLUME 723 AT PAGE 396 OF OFFICIAL RECORDS, A LOT LINE ADJUSTMENT BETWEEN LOTS 5 AND 6 SHOWN ON MAP OF TRACT NO 36-20 RECORDED IN BOOK 8 OF MAPS AT PAGE 1 IN THE OFFICE OF THE MONO COUNTY RECORDER. LOCATED IN A PORTION OF THE SW 1/4 OF SECTION 35, TOWNSHIP 3 SOUTH, RANGE 27 EAST, MOUNT DIABLO BASELINE & MERIDIAN. IN THE TOWN OF MAMMOTH LAKES, COUNTY OF MONO, STATE OF CALIFORNIA.

SURVEYOR'S STATEMENT:

THIS MAP CORRECTLY REPRESENTS A SURVEY MADE BY ME OR UNDER MY DIRECTION IN CONFORMANCE WITH THE REQUIREMENTS OF THE LAND SURVEYORS' ACT AT THE REQUEST OF JOHN W. HOOPER. IN SEPTEMBER 1995.

DAVID LAVERTY
L.S. 4587

DATE
LIC. EXP. 9-30-98

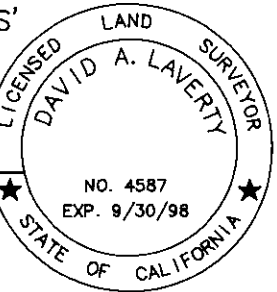

COUNTY SURVEYOR'S STATEMENT:

THIS MAP HAS BEEN EXAMINED IN ACCORDANCE WITH SECTION 8766 OF THE LAND SURVEYORS' ACT THIS 12TH DAY OF DECEMBER 1995.

COUNTY SURVEYOR

RICHARD BOARDMAN
L.S. 4686

DATE
12/19/95

LIC. EXP. 9-30-99



LEGEND

- SET 5/8" REBAR WITH CAP, "L.S. 4587"
- FOUND MONUMENT AS NOTED
- R1 RECORD DATA PER MB 8/1
- R2 RECORD DATA PER RSMB 2/81
- CFR CALCULATED FROM RECORD
- M MEASURED

RECORDER'S STATEMENT:

FILED THIS 22nd DAY OF December 1995, AT 10:38 A.M. IN BOOK 3 OF RECORD OF SURVEY MAPS AT PAGE 37 AT THE REQUEST OF JOHN W. HOOPER.

INSTRUMENT NO. : # 4659
FEE : \$5.00

RENN NOLAN
MONO COUNTY RECORDER

BY : Vera M. Malle
DEPUTY COUNTY RECORDER

BASIS OF BEARINGS

THE BASIS OF BEARINGS FOR THIS SURVEY IS THE CENTERLINE OF SIERRA MANORS ROAD AS SHOWN ON MB 8/1 SHOWN HEREON AS N 02°02'06" E.

